

Stepper Motor with Gearhead PN 16423

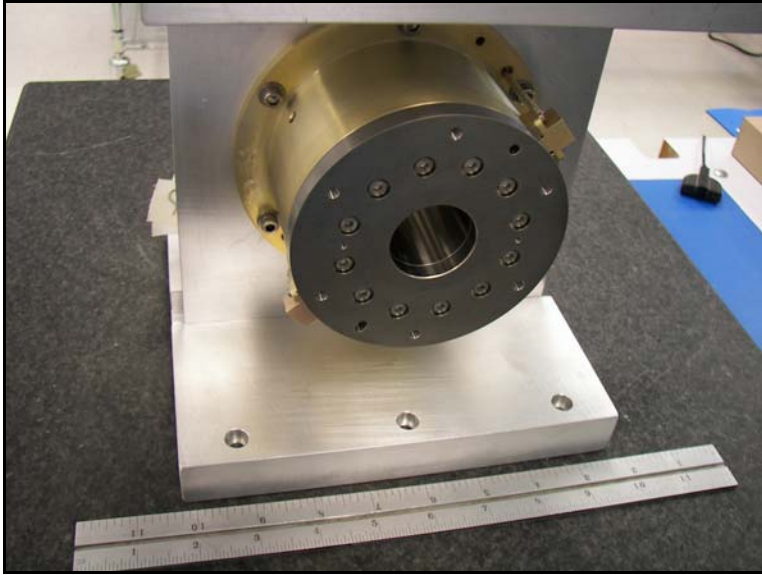

Specification	Value	Units	Basis
Gear Ratio	160:1	ratio	By Design
Output Step Angle	0.009375	degrees	Nominal
Running Torque	190	in-lb	Nominal
Holding Torque	495	in-lb	Nominal
Unpowered Torque	97	in-lb	Nominal
Backlash	0	degrees	Maximum
Weight	8.8	pounds	Nominal

Motor Specification	Value	Units	Basis
Step Angle	1.5	degrees	Nominal
Step Rate	256	pps	Maximum
Voltage	23.0	volts DC	Maximum
Power	8	watts	Maximum
Phase Resistance	80	ohms	Nominal
Phase Inductance	0.78	mH	Nominal
Phases/Poles	3/80	phases/poles	By Design
Redundant Windings	Yes	windings	By Design

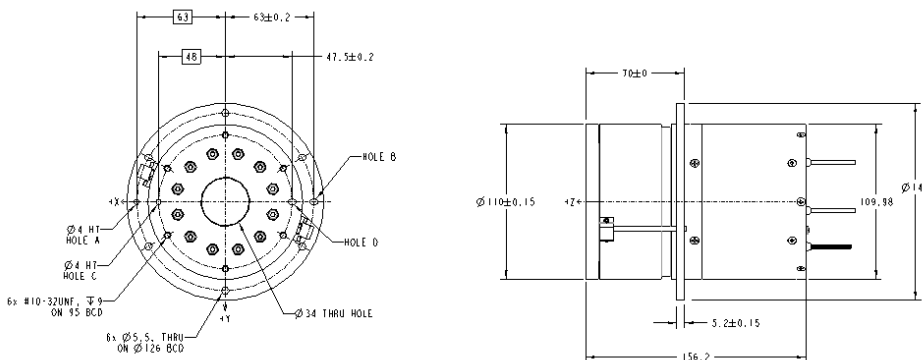

For the very latest specifications visit www.aeroflex.com/Motion