

ATTENUATORS

BNC, DC -2 GHz, 2 Watts

SPECIFICATIONS:

Models: 9073-XX

RoHS
Compliant

AEROFLEX
A passion for performance.

Electrical:

Frequency Range _____ DC - 2 GHz
Standard dB Values* _____ 0 - 10, 12, 15, 20 & 30 dB
In 1 dB Increments
Attenuation Accuracy
1 - 20 dB _____ ±0.5 dB
30 dB _____ ±0.75 dB
VSWR _____ 1.20:1 Max
Input Power _____ 2 Watts Avg.
Impedance _____ 50 Ohms
Operating Temp. Range _____ -65°C to +125°C

Mechanical:

BNC Connectors _____ Nickel Plated Brass
Mates with MIL-STD-348
Conductors _____ Gold Plated Beryllium Copper or Brass

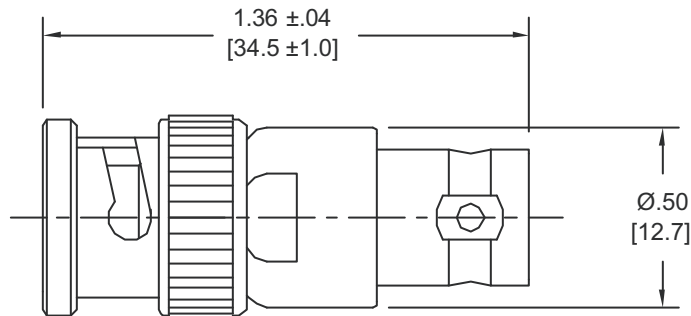

MALE/MALE & FEMALE/FEMALE VERSIONS ARE ALSO AVAILABLE, SEE INMET MODEL NUMBERS 9014, 9015 & 9016 FOR MORE BNC OPTIONS

HOW TO ORDER:

Model Number: **9073-XX**

└── dB Value

Ordering Examples:

Model Number: **9073-20**
20 dB; BNC - Male/Fem

Model Number: **9073-6**
6 dB; BNC - Male/Fem

Note: Dimensions in Brackets are Expressed in Millimeters and are for Reference Only.
*Other dB values are also available.

9073: REV H

AEROFLEX
INMET

Aeroflex / Inmet, Inc. • 300 Dino Drive, Ann Arbor, MI 48103 • U.S.A.
888-244-6638 or 734-426-5553 • FAX: 734-426-5557
www.aeroflex.com/inmet • inmet-sales@eroflex.com