

Zener Diode Chip Series

CD4678 thru CD4717



Features

- All junctions completely protected with silicon dioxide
- Electrically equivalent to IN4678 thru IN4717
- 0.5 Watt capability with proper heat sinking
- 50 μ A low operating current Zener Diodes
- Compatible with all wire bonding and die attach techniques with the exception of solder reflow

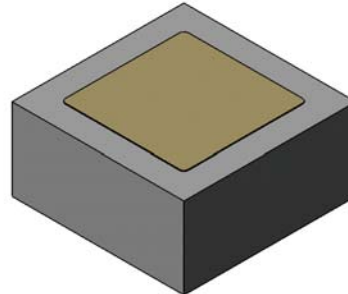

Maximum Ratings

Operating Temperature: -65°C to +175°C

Storage Temperature: -65°C to +175°C

Forward Voltage @ 200mA: 1.5 volts maximum

Electrical Specifications @ +25 °C (Unless Otherwise Specified)

CDI TYPE NUMBER (NOTE 1)	NOMINAL ZENER VOLTAGE V_Z (NOTE 3)	ZENER TEST CURRENT I_{ZT}	MAXIMUM VOLTAGE REGULATION $\%V_Z$ (NOTE 2)	MAXIMUM MAXIMUM REVERSE $I_R @ V_R$		MAXIMUM DC ZENER CURRENT I_{ZM}
				μ A	VOLTS	
CD4678	1.8	50	0.70	7.5	1.0	120.0
CD4679	2.0	50	0.70	5.0	1.0	110.0
CD4680	2.2	50	0.75	4.0	1.0	100.0
CD4681	2.4	50	0.80	2.0	1.0	90.0
CD4682	2.7	50	0.80	1.0	1.0	90.0
CD4683	3.0	50	0.90	0.8	1.0	85.0
CD4684	3.3	50	0.95	7.5	1.5	80.0
CD4685	3.6	50	0.95	7.5	2.0	75.0
CD4686	3.9	50	0.97	5.0	2.0	70.0
CD4687	4.3	50	0.99	4.0	2.0	65.0
CD4688	4.7	50	0.99	10.0	3.0	60.0
CD4689	5.1	50	0.97	10.0	3.0	55.0
CD4690	5.6	50	0.96	10.0	4.0	50.0
CD4691	6.2	50	0.95	10.0	5.0	45.0
CD4692	6.8	50	0.90	10.0	5.1	35.0
CD4693	7.5	50	0.75	10.0	5.7	31.8
CD4694	8.2	50	0.50	1.0	6.2	29.0
CD4695	8.7	50	0.10	1.0	6.6	27.4
CD4696	9.1	50	0.08	1.0	6.9	26.2
CD4697	10.0	50	0.10	1.0	7.6	24.8
CD4698	11.0	50	0.11	0.05	8.4	21.6
CD4699	12.0	50	0.12	0.05	9.1	20.4
CD4700	13.0	50	0.13	0.05	9.8	19.0
CD4701	14.0	50	0.14	0.05	10.6	17.5
CD4702	15.0	50	0.15	0.05	11.4	16.3
CD4703	16.0	50	0.16	0.05	12.1	15.4
CD4704	17.0	50	0.17	0.05	12.9	14.5
CD4705	18.0	50	0.18	0.05	13.6	13.2
CD4706	19.0	50	0.19	0.05	14.4	12.5
CD4707	20.0	50	0.20	0.01	15.2	11.9
CD4708	22.0	50	0.22	0.01	16.7	10.8
CD4709	24.0	50	0.24	0.01	18.2	9.9
CD4710	25.0	50	0.25	0.01	19.0	9.5
CD4711	27.0	50	0.27	0.01	20.4	8.8
CD4712	28.0	50	0.28	0.01	21.2	8.5
CD4713	30.0	50	0.30	0.01	22.8	7.9
CD4714	33.0	50	0.33	0.01	25.0	7.2
CD4715	36.0	50	0.36	0.01	27.3	6.6
CD4716	39.0	50	0.39	0.01	29.8	6.1
CD4717	43.0	50	0.43	0.01	32.6	5.5

NOTE 1 The JEDEC type numbers shown above have a standard tolerance of $\pm 5\%$ of the nominal Zener voltage. V_Z is measured with the diode in thermal equilibrium at 25 °C ± 3 °C

NOTE 2 $V_Z @ 100 \mu$ A minus $V_Z @ 10 \mu$ A.

NOTE 3 Zener voltage is read using a pulse measurement, 10 milliseconds maximum.



Outline Drawing

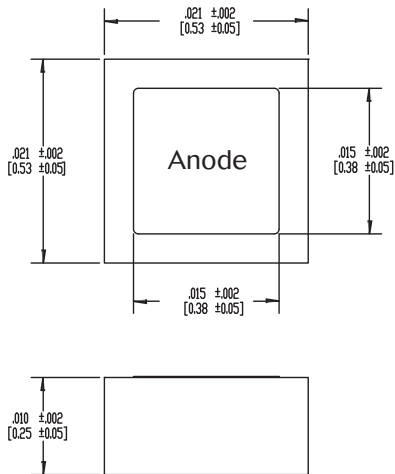

DESIGN DATA

METALLIZATION: Top: (Anode) Al
Back: (Cathode) Au

AL THICKNESS: 25,000 Å Minimum

GOLD THICKNESS: 4,000 Å Minimum

CHIP THICKNESS: 10 Mils

CIRCUIT LAYOUT DATA: For Zener operation, cathode must be operated positive with respect to anode.

Graphs

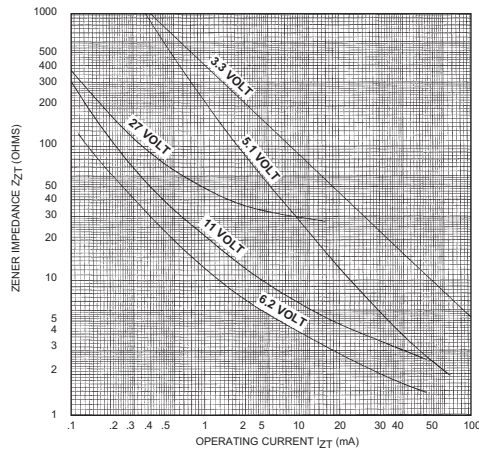

ZENER IMPEDANCE VS. OPERATING CURRENT

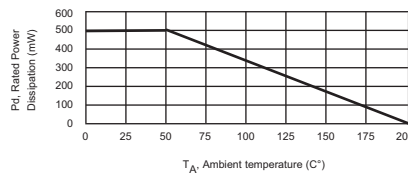

POWER DERATING CURVE

Aeroflex / Metelics, Inc.

975 Stewart Drive,
Sunnyvale, CA 94085
Tel: (408) 737-8181
Fax: (408) 733-7645

Sales: 888-641-SEMI (7364)

Hi-Rel Components

9 Hampshire Street,
Lawrence, MA 01840
Tel: (603) 641-3800
Fax: (978) 683-3264

www.aeroflex.com/metelics-hirelcomponents

54 Grenier Field Road,
Londonderry, NH 03053
Tel: (603) 641-3800
Fax: (603)-641-3500

www.aeroflex.com/metelics metelics-sales@eroflex.com

Aeroflex / Metelics, Inc. reserves the right to make changes to any products and services herein at any time without notice. Consult Aeroflex or an authorized sales representative to verify that the information in this data sheet is current before using this product. Aeroflex does not assume any responsibility or liability arising out of the application or use of any product or service described herein, except as expressly agreed to in writing by Aeroflex; nor does the purchase, lease, or use of a product or service from Aeroflex convey a license under any patent rights, copyrights, trademark rights, or any other of the intellectual rights of Aeroflex or of third parties.

Copyright 2011 Aeroflex / Metelics. All rights reserved.

ISO 9001: 2008 certified companies



Our passion for performance is defined by three attributes represented by these three icons: solution-minded, performance-driven and customer-focused.