

# TERMINATIONS

TNC, up to 18 GHz, 50 Watts

## SPECIFICATIONS:

Models: TTXXM-50W, TTXXF-50W

**RoHS**  
Compliant

**AEROFLEX**  
A passion for performance.

### Electrical:

Frequency Range \_\_\_\_\_ DC - 18 GHz  
Standard Freq. Values \_\_\_\_\_ 6 & 18 GHz  
VSWR

DC - 6 GHz \_\_\_\_\_ 1.25:1 Max.  
6 - 12.4 GHz \_\_\_\_\_ 1.35:1 Max.  
12.4 - 18 GHz \_\_\_\_\_ 1.45:1 Max.

Impedance \_\_\_\_\_ 50 Ohms  
Input Power \_\_\_\_\_ 50 Watts Avg. @ +25°C  
Derated Linearly to 10 Watts @ +125°C

Peak Power \_\_\_\_\_ 500 Watts Max.  
(5uSec Pulse, .05% Duty Cycle)

Operating Temp Range \_\_\_\_\_ -65°C to +125°C

### Mechanical:

TNC Connectors\* \_\_\_\_\_ Passivated Stainless Steel  
Mates with MILSTD-348

Housing \_\_\_\_\_ Anodized Aluminum

Conductors \_\_\_\_\_ Gold Plated Beryllium Copper

\*TNC Connectors Mode-Free to 18 GHz

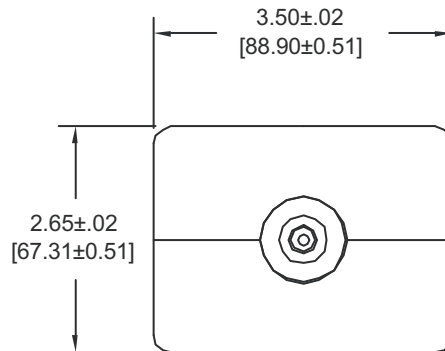

END VIEW  
TYPICAL

Model Number: **TTXXF-50W**

TNC Female Connector  
Length: 3.91 ±.05 [99.3 ±1.3]  
As Pictured

Model Number: **TTXXM-50W**

TNC Male Connector  
Length: 3.81 ±.05 [96.8 ±1.3]

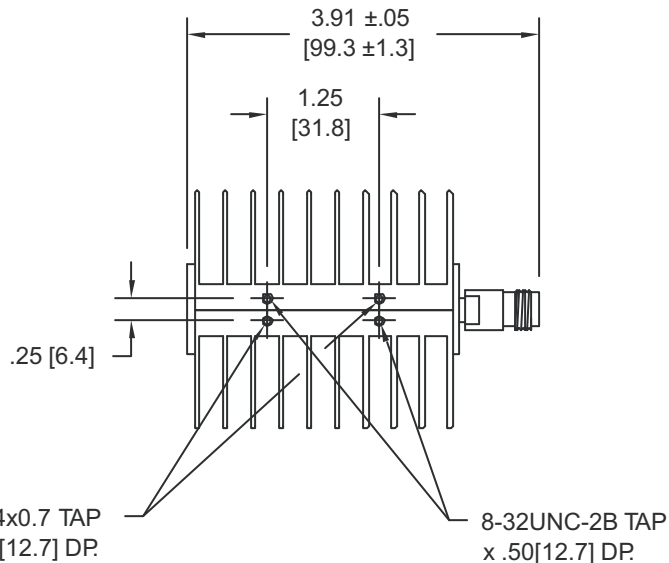

Units must be Mounted in such a way as to Allow for Free Air Flow Around fins to Insure Performance

## HOW TO ORDER:

Model Number: **TTXXXY-50W**

Frequency Range   Connector Configuration  
060 = DC - 6 GHz M = Male  
180 = DC - 18 GHz F = Female

## Ordering Examples:

Model Number: **TT060F-50W**  
DC - 6 GHz; TNC Female

Model Number: **TT180M-50W**  
DC - 18 GHz; TNC Male

Note: Dimensions in Brackets are Expressed in Millimeters and are for Reference Only.  
Design specifications are subject to change without notice.  
Contact factory for technical specifications before purchasing or use.

TT180-50W: REV G (M)

**AEROFLEX**  
INMET

Aeroflex / Inmet, Inc. • 300 Dino Drive, Ann Arbor, MI 48103 • U.S.A.  
888-244-6638 or 734-426-5553 • FAX: 734-426-5557  
www.aeroflex-inmet.com • inmet-sales@eroflex.com