

ADAPTERS, BETWEEN SERIES

2.4mm / 3.5mm, DC - 34 GHz

SPECIFICATIONS:

Models: 5065, 5066, 5067, 5068

RoHS
Compliant

Electrical:	
Frequency Range _____	DC - 34 GHz
VSWR _____	1.25:1 Max.
Impedance _____	50 Ohms
Operating Temp. Range _____	-65°C to +125°C
Mechanical:	
2.4mm Connectors _____	Passivated Stainless Steel
Mates with 1.85mm & V* Connectors	
3.5mm Connectors _____	Passivated Stainless Steel
Mates both Mechanically and Electrically with all SMA, K* Series Connectors	
Conductors _____	Gold Plated Beryllium Copper

*K and V are trademarks of Anritsu Corp.

Model Number: **5065**
2.4mm MALE / 3.5mm MALE

Model Number: **5066**
2.4mm MALE / 3.5mm FEMALE

2x 5/16 HEX

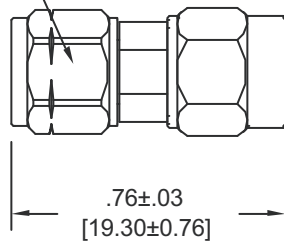

5/16 HEX

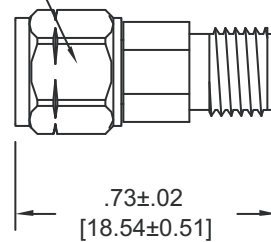

Model Number: **5067**
2.4mm FEMALE / 3.5mm MALE

Model Number: **5068**
2.4mm FEMALE / 3.5mm FEMALE

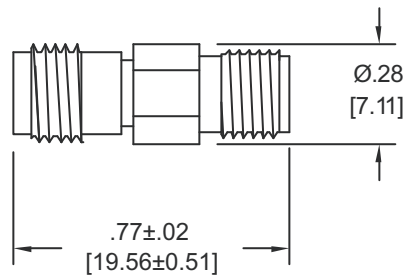
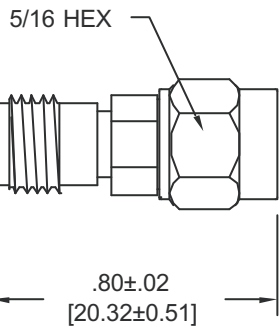

Note: Dimensions in Brackets are Expressed in Millimeters and are for Reference Only.
Units that offer very low return loss (VSWR) are also available.

5065: REV -



Aeroflex / Inmet, Inc. • 300 Dino Drive, Ann Arbor, MI 48103 • U.S.A.
888-244-6638 or 734-426-5553 • FAX: 734-426-5557
www.aeroflex.com/inmet • inmet-sales@eroflex.com

